

(Implemented Approval Ref:17/01946/FUL)

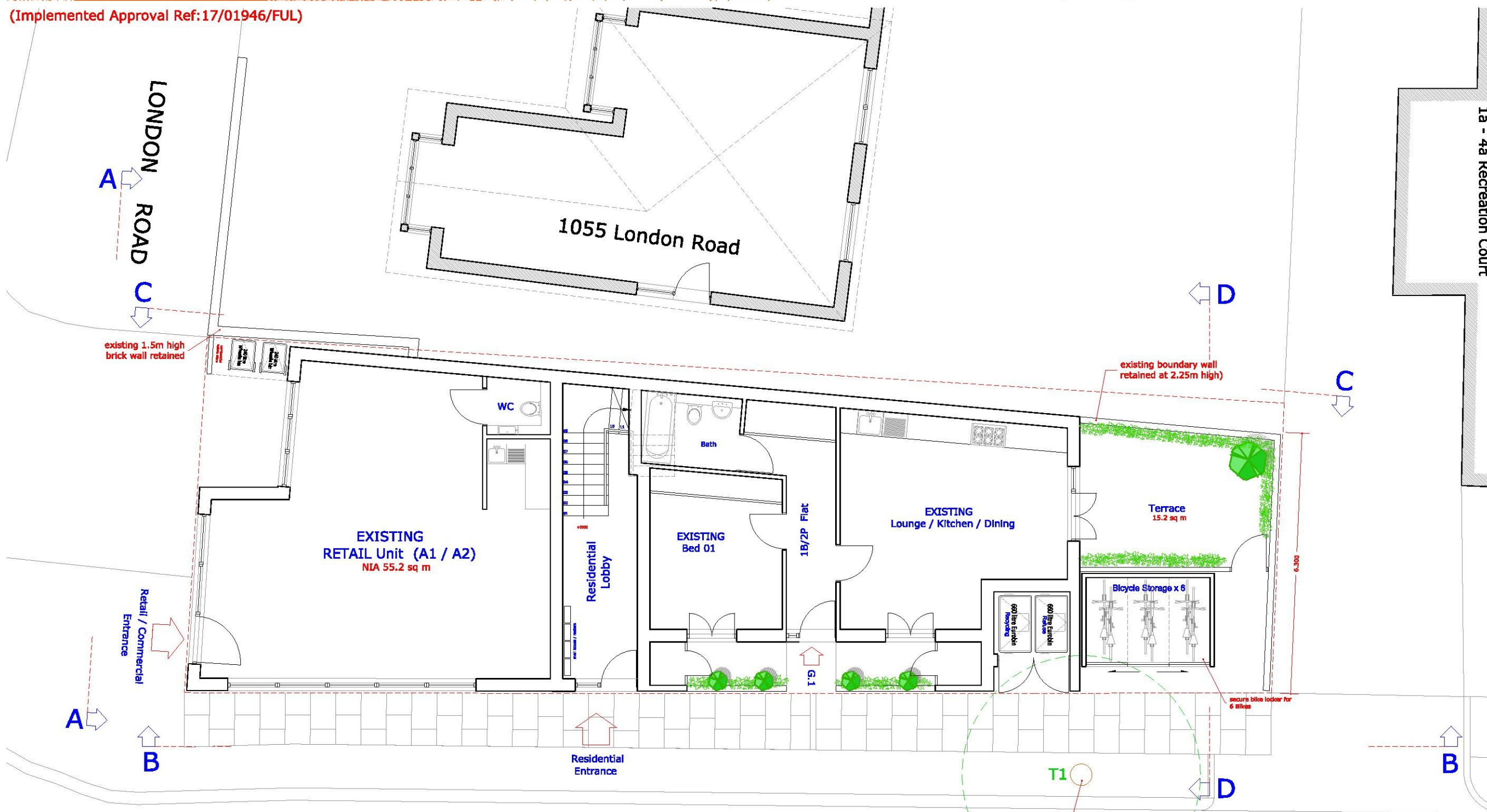

This drawing is intended as an initial appraisal of the site only. Do not use for the purposes of valuation. This drawing has been produced using OS information and 3rd party drawings prepared by others. It is advised that a full measured survey and detailed site inspection is undertaken by the client / contractor prior to the commencement of works.

The drawings are subject to planning approval and landlord licence.

All building work must comply with relevant British Standards and Building Regulations. All dimensions to be checked on site prior to the commencement of works and any discrepancies or omissions referred to the Architect / Engineer / Contractor.

The ownership of copyright of this drawing remains the property of Studio:08 architecture + planning ltd in accordance with the Copyright Design + Patents Act 1988.

Reproduction of this drawing or its content, wholly or in part is prohibited without written approval. No implied licence exists.

NB: If a hard copy of this drawing is to be printed at a remote source by a 3rd party it could result in minor distortions in the original scale. It is advised to verify the original scale has been reproduced accurately by checking the visual scales on the drawing.

Site Location Plan  
1:1250 @ A3 scale

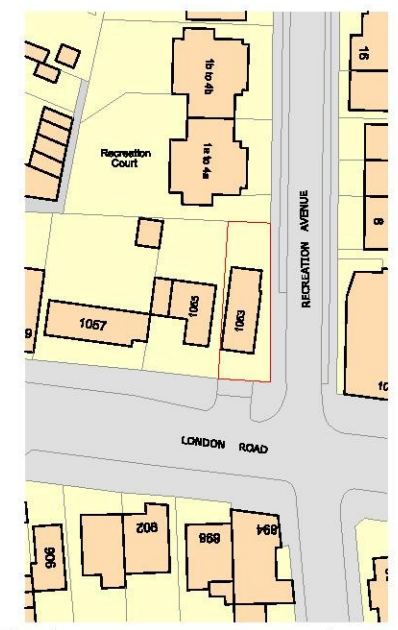

Rev	Detail	Date
Drawing No. : 2000.EX.11		Revision :
Scale : 1:100 @ A3 1:50 @ A1		Date : 24.02.19

Project Title:  
1053 London Road  
Leigh-on-Sea SS9 3JP

Drawing Title :  
EXISTING  
Ground Floor Plan



1053 London Road, Leigh-on-Sea SS9 3JP

EXISTING  
Ground Floor Plan

scale 1:50 @ A1 / 1:100 @ A3



RECREATION AVENUE